



P Y G A R  
TOOLS FOR PROFESSIONALS



CATALOG

# Sole importer of FELCO, SWIZA, TINA and ISTOR products in USA and Canada.

---

In a world of standardization, driven by short-term goals, PYGAR has chosen to maintain the tradition to offer the highest standards of excellence, durability and sustainability in the products it sells; there never will be a compromise.

FELCO, TINA and ISTOR are known worldwide as unsurpassed leaders in the manufacture of pruning, cutting and sharpening tools; made to last and give satisfaction for many years of intensive use.

Made in Switzerland and Germany, these tools are designed with the professional in mind and produced with state-of-the-art technology, decades of know-how and the tradition of quality workmanship.

FELCO, TINA and ISTOR are multi-generation family owned manufacturers continuously striving for excellence to serve the most demanding professionals. We will make sure that your experience with PYGAR will commit to the absolute best quality products the industry has to offer.



# Distributor of SILKY and BERGER products.

---

When PYGAR's core brands are in need of a compliment we provide two additional brands to complete the portfolio.

SILKY saws are manufactured in Ono Japan, home of fine cutlery steel. Crafting fine wood cutting saws since the early 1900s, SILKY continues to raise the bar for quality, endurance and cutting efficiency that few can match. Leading the industry in both design and innovation, saw users are changing their language in all parts of the world from merely asking for a saw, to asking for a SILKY.

In 1918, Julius Berger started making quality garden tools in Wuppertal-Cronenberg, Germany. These tools were designed on site and made by machines that Julius designed himself. Since that time Arno Berger (1972) and Ina & Julian (2005) have carried on the BERGER name, making quality garden tools for gardeners around the world. PYGAR is happy to offer two styles of their hedge trimmer product.



**BERGER**  
made to cut. 1919

# CONTENTS

## GREEN RANGE.....6

### ONE-HAND PRUNERS | CLASSIC .....6

FELCO 2 .....	6
FELCO 11 .....	6
FELCO 100 .....	6
FELCO 4 .....	6
FELCO 4 C&H .....	6

### ONE-HAND PRUNERS | EXPERTS.....6

FELCO 8 .....	6
FELCO 7 .....	6
FELCO 9 .....	6
FELCO 10 .....	6
FELCO 6 .....	6
FELCO 16 .....	6
FELCO 12 .....	6
FELCO 17 .....	6
FELCO 14 .....	6
FELCO 15 .....	6

### ONE-HAND PRUNERS | ESSENTIAL AND SNIPS ....7

FELCO 5 .....	7
FELCO 160L .....	7
FELCO 160S .....	7
FELCO 300 .....	7
FELCO 310 .....	7

### ONE-HAND PRUNERS | SPECIALTIES .....7

FELCO 31 .....	7
FELCO 32 .....	7
FELCO 19 .....	7
FELCO 13 .....	7
FELCO 50 .....	7
FELCO 51 .....	7

## MAJOR SPARE PARTS FOR ONE HAND PRUNERS 8

### LOPPERS - NEW .....9

FELCO 211 series .....	9
F211A40 .....	9
F211A50 .....	9
F211A60 .....	9

### SPARE PARTS FOR FELCO 211 LOPPER LINE.....9

### LOPPERS | EXPERTS ..... 10

FELCO 200 series .....	10
F200A40 .....	10
F200A50 .....	10
F200A60 .....	10
F200C60 .....	10
FELCO 210 series .....	10
F210A50 .....	10
F210A60 .....	10
F210C60 .....	10

F210A50 .....	10
F210A60 .....	10
F210C60 .....	10
FELCO 220 .....	10
FELCO 230 .....	10
FELCO 231 .....	10

### LOPPERS | CLASSIC.....11

FELCO 20 .....	11
FELCO 21 .....	11
FELCO 22 .....	11

### MAJOR SPARE PARTS FOR LOPPERS .....11

### HORTICULTURE KNIVES.....12

LIGHT PRUNING .....	12
ROSE BUDDING .....	12
FRUIT TREE BUDDING .....	12
ALL PURPOSE.....	12
LIGHT GRAFTING AND PRUNING .....	12
ALL PURPOSE BUDDING KNIFE .....	12
PRUNING OR LARGE TREE GRAFTING .....	12
HEAVY PRUNING AND DESUCKERING.....	12
PARING KNIVES.....	12

### FELCO POCKET KNIFE SERIES.....13

FELCO 500 .....	13
FELCO 501 .....	13
FELCO 502 .....	13
FELCO 503 .....	13
FELCO 504 .....	13
FELCO 505 .....	13
FELCO 506 .....	13

### SAWS.....14

FELCO 600 .....	14
FELCO 621 .....	14
FELCO 611 .....	14
FELCO 640 .....	14
FELCO 630 .....	14

### ACCESSORIES .....14

MAINTENANCE.....	14
F902 .....	14
F903 .....	14
F904 .....	14
F980 .....	14
F990 .....	14
LEATHER HOLSTERS .....	15
FELCO 910 .....	15
FELCO 910+ .....	15
FELCO 911 .....	15
FELCO 912 .....	15
FELCO 916 .....	15
FELCO 918 .....	15



FELCO 919 .....	15
FELCO 920 .....	15
FELCO 921 .....	15
FELCO 923 .....	15
<b>INDUSTRIAL RANGE .....</b>	<b>16</b>
CABLE CUTTERS .....	16
FELCO CDO.....	16
FELCO CP .....	16
FELCO C3.....	16
FELCO C7.....	16
FELCO C9.....	16
FELCO C12.....	16
FELCO C16.....	16
FELCO C16E.....	16
FELCO C108.....	16
FELCO C112.....	16
<b>POWER ASSISTED RANGE   FELCOmatic .....</b>	<b>17</b>
PNEUMATIC PRUNING SHEARS .....	17
FELCO 70 .....	17
<b>MAJOR SPARE PARTS FOR PNEUMATIC SHEARS .</b>	<b>17</b>
F73 .....	17
F75 .....	17
F76 .....	17
F77 .....	17
<b>POWER ASSISTED RANGE   FELCOtronic .....</b>	<b>18</b>
ELECTROPORTABLE PRUNING SHEARS .....	18
FELCO 801 .....	18
FELCO 811 .....	18
FELCO 822 .....	18
FELCO 880/100-100.....	18
FELCO 880/100-150.....	18
FELCO 882 POWERPACK .....	18
MAJOR SPARE PARTS FOR ELECTRIC SHEARS.....	19
FELCOtronic GREASE PUMP REFILL.....	19
FELCOtronic CHARGER.....	19
FELCOtronic BATTERIES.....	19
880/193 .....	19
880/194 .....	19
<b>MARKETING MATERIAL .....</b>	<b>20</b>
DISPLAYS .....	20
92331 .....	20
92332 .....	20
92333 .....	20
92355 .....	20
DISPLAYS ACCESSORIES.....	20
92334 .....	20
92321 .....	20
CATALOGS .....	20
90804 .....	20
90103 .....	20
90415 .....	20
90416 .....	20
90413 .....	20

SWISS ARMY KNIVES .....	21
91015 .....	21
91016 .....	21
POUCHES.....	21
P731 .....	21
PENS .....	21
91055 .....	21
HATS.....	21
91079 .....	21
<b>TINA KNIVES.....</b>	<b>22</b>
T600A-12 .....	22
T605 .....	22
T606 .....	22
T607 .....	22
T608 .....	22
T683 .....	22
T685 .....	22
T640-10 .....	23
T641-10 .....	23
T642-10 .....	23
T645-9F .....	23
T648-10 .....	23
T650-105E.....	23
T650-105S.....	23
T671 .....	23
T613-105 .....	24
T620-10 .....	24
T626-11 .....	24
T630-11 .....	24
T900 .....	24
T940 .....	24
<b>SWISS ISTOR SHARPENER.....</b>	<b>25</b>
I-10 .....	25
I-15 .....	25
I-20 .....	25
<b>BERGER.....</b>	<b>26</b>
B-4490.....	26
B-4590.....	26
<b>SILKY .....</b>	<b>27</b>
HAYATE POLE SAW - XLG TEETH .....	27
H-371.....	27
H-372.....	27
HAYAUCHI POLE SAW   XLG TEETH .....	27
S-78.....	27
S-79.....	27
ZUBAT CURVED SAW   LG TEETH .....	27
S-300.....	27
ZUBAT POLE SAW   LG TEETH.....	27
S-330.....	27

# GREEN RANGE



## ONE-HAND PRUNERS | CLASSIC *Strength, reliability and versatility*

### FELCO 2

*The Icon - thick & rigid anvil blade*

### FELCO 11

*Similar to F2 with thinner anvil blade*

### FELCO 100

*F11 with cut and hold blades  
Primary model for roses*

### FELCO 4

*Simplified version of F2*

### FELCO 4 C&H

*F4 with cut and hold blades  
Primary model for roses*

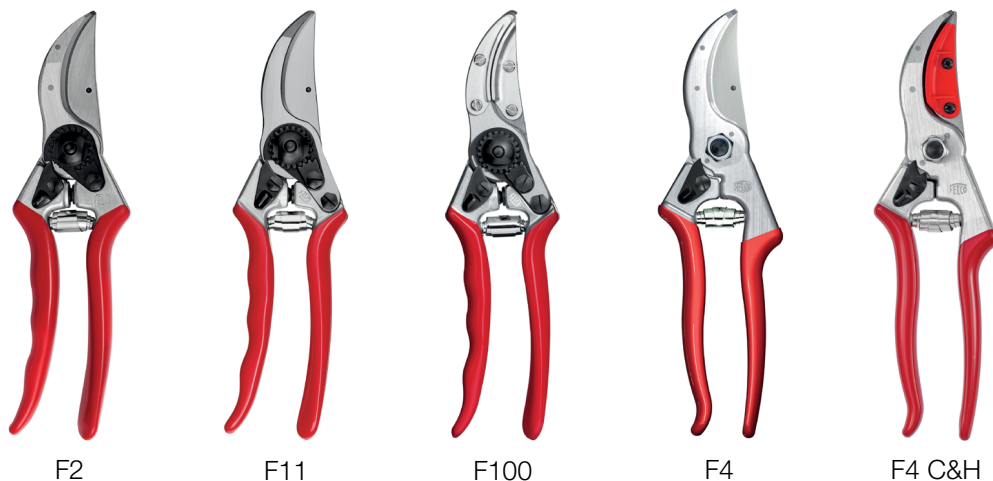

## ONE-HAND PRUNERS | EXPERTS *Ergonomy, strength and reliability*

### FELCO 8

*Large handles*

### FELCO 7

*F8 with rotating handle*

### FELCO 9

*Left handed F8*

### FELCO 10

*F9 with rotating handle*

### FELCO 6

*Medium handles*

### FELCO 16

*Left handed F6*

### FELCO 12

*F6 with rotating handle*

### FELCO 17

*Left handed F12*

### FELCO 14

*Small handles*

### FELCO 15

*F14 with rotating handle*

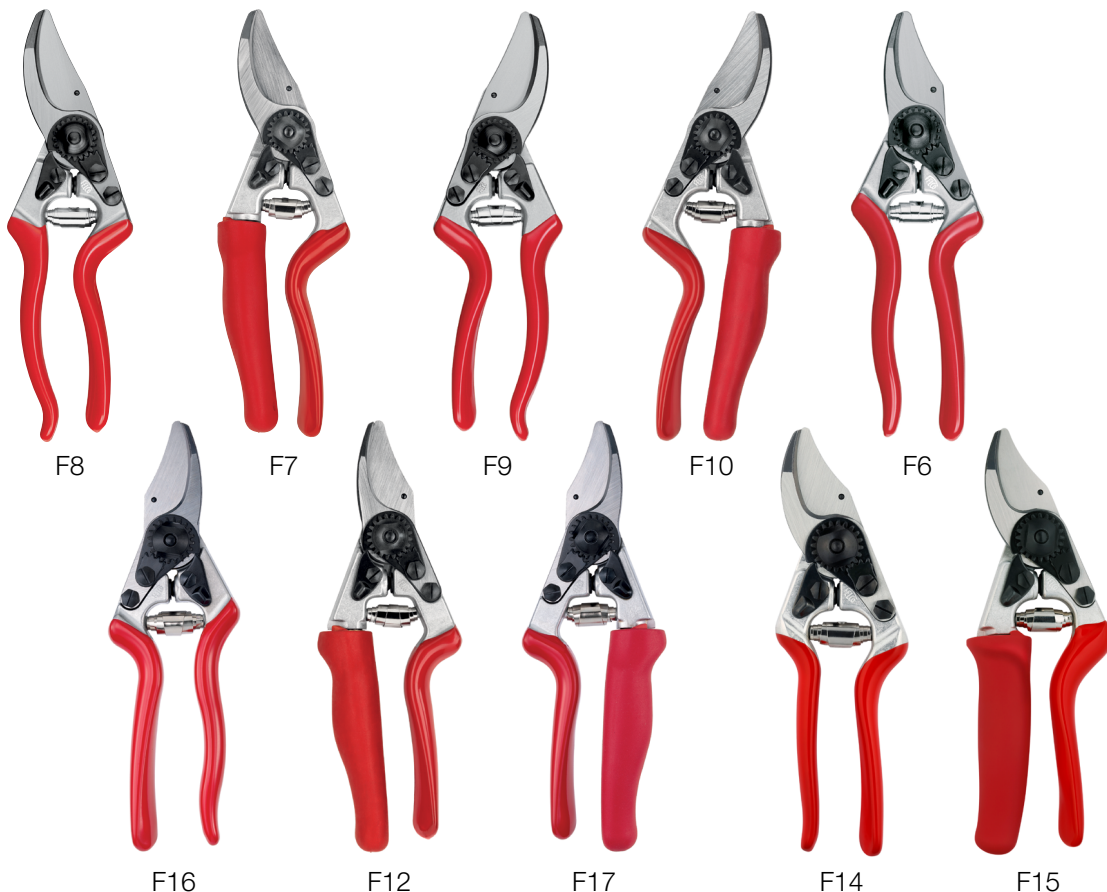

# GREEN RANGE



## ONE-HAND PRUNERS | ESSENTIAL AND SNIPS *Reliability, versatility and affordability*

### FELCO 5

*M/L handles made of steel*

### FELCO 160L

*M/L handles made of composite*

### FELCO 160S

*S/M handles made of composite*

### FELCO 300

*Flower and herb pruner*

### FELCO 310

*Fruit harvesting pruner*



F5



F160L



F160S



F300



F310

## ONE-HAND PRUNERS | SPECIALTIES

### FELCO 31

*Anvil pruner - Straight anvil*

### FELCO 32

*Anvil pruner - Curved anvil*

### FELCO 19

*F8 with spray device*

### FELCO 13

*Large/X-Large handles*

### FELCO 50

*Hoof shear with rotating handle*

### FELCO 51

*Hoof shear without rotating handle*



F31



F32



F19



F13



F50



F51

# GREEN RANGE



## MAJOR SPARE PARTS FOR ONE HAND PRUNERS [Visit felco.com](http://felco.com)

BLADES	F2	F4	F5	F6/12	F7/8	F9/10	F11	F13	F14/15	F16/17	F31	F32	F50/51	F100	F160S	F160L
2/3																
5/3																
6/3																
7/3																
9/3																
13/3																
14/3																
16/3																
30/3																
32/3																
50/3																
100/3																
160S/3																

ANVIL BLADES	F2	F4	F5	F6/12	F7/8	F9/10	F11	F13	F14/15	F16/17	F31	F32	F50/51	F100	F160S	F160L
2/4																
4/4																
6/4																
7/4																
9/4																
11/4																
13/4																
14/4																
16/4																
31/4																
32/4																
50/4																
100/4																
160S/4																
160L/4																

SPRINGS	F2	F4	F5	F6/12	F7/8	F9/10	F11	F13	F14/15	F16/17	F31	F32	F50/51	F100	F160S	F160L
2/91																
5/91																
6/91																
30/91																

BOLT & NUT SETS	F2	F4	F5	F6/12	F7/8	F9/10	F11	F13	F14/15	F16/17	F31	F32	F50/51	F100	F160S	F160L
2/90																
2/94																
4/90																
5/94																
6/90																
6/94																
7/90																
7/94																
30/90																
160/94																

REPAIR & ½ OPENING SETS	F2	F4	F5	F6/12	F7/8	F9/10	F11	F13	F14/15	F16/17	F31	F32	F50/51	F100	F160S	F160L
2/92																
2/92B																
30/92																



# GREEN RANGE



## LOPPERS *Strength, reliability and value*

FELCO 211 series

*Curved cutting head*

*Cutting capacity of 30 mm/1.2 in*

F211A40

40 cm/15.7 in

F211A50

50 cm/19.7 in

F211A60

60 cm/23.6 in



F211A40



F211A50



F211A60

## SPARE PARTS FOR FELCO 211 LOPPER LINE

*\*New lopper line parts are interchangeable except for the handles parts 211/22, 211/32, 211/42*

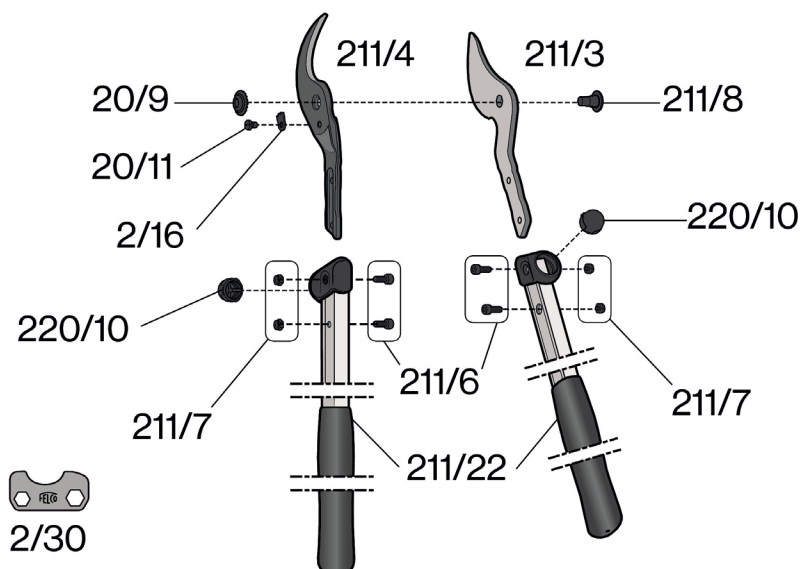

# GREEN RANGE



## LOPPERS | EXPERTS *Ergonomy, strength and reliability*

### FELCO 200 series

*Straight cutting head*

*Cutting capacity of 30 mm/1.2 in*

**F200A40**

*40 cm/15.7 in*

**F200A50**

*50 cm/19.7 in*

**F200A60**

*60 cm/23.6 in*

**F200C60**

*60 cm/23.6 in  
carbon, ultra light*



F200A40



F200A50



F200A60



F200C60

### FELCO 210 series

*Curved cutting head*

*Cutting capacity of 35 mm/1.4 in*

**F210A50**

*50 cm/19.7 in*

**F210A60**

*60 cm/23.6 in*

**F210C60**

*60 cm/23.6 in  
carbon, ultra light*



F210A50



F210A60



F210C60

### FELCO 220

*Cutting capacity of 40 mm/1.6 in*

*By-pass with lever-action*

*80 cm/31.5 in - 1335 gr/47.1 oz*



F220

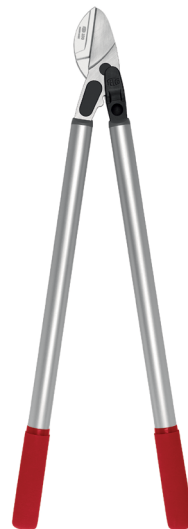

F230



F231

### FELCO 230

*Cutting capacity of 40 mm/1.6 in*

*Straight anvil with lever-action*

*80 cm/31.5 in - 1150 gr/40.5 oz*

### FELCO 231

*Cutting capacity of 40 mm/1.6 in*

*Curved anvil with lever-action*

*80 cm/31.5 in - 1150 gr/40.5 oz*

# GREEN RANGE



## LOPPERS | CLASSIC Strength, reliability and versatility

### FELCO 20

Cutting capacity of 35 mm/1.4 in  
By-pass, forged aluminium handles  
43 cm/16.9 in - 790 gr/27.0 oz

### FELCO 21

Cutting capacity of 35 mm/1.4 in  
By-pass, forged aluminium handles  
63 cm/24.8 in - 1150 gr/40.0 oz

### FELCO 22

Cutting capacity of 45 mm/1.8 in  
By-pass, forged aluminium handles  
84 cm/33.1 in - 1980 gr/69.8 oz



F20



F21

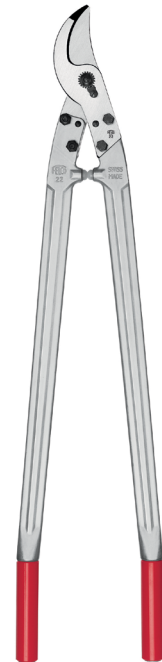

F22

## MAJOR SPARE PARTS FOR LOPPERS Visit [felco.com](http://felco.com)

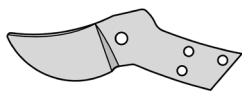

BLADES	F20	F21	F22	F200	F210	F220	F230	F230
22/3								
200/3								
210/3								
220/3								

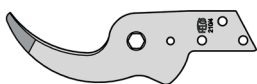

ANVIL BLADES - ANVILS	F20	F21	F22	F200	F210	F220	F230	F230
22/4								
200/4								
210/4								
220/4								
230/4								
231/4								



SHOCK ABSORBERS	F20	F21	F22	F200	F210	F220	F230	F230
20/93								
21/93								
220/93								



REPAIR SET	F20	F21	F22	F200	F210	F220	F230	F230
20/92								

# GREEN RANGE



## HORTICULTURE KNIVES

Stainless steel blades | Made by VICTORINOX

### LIGHT PRUNING

3.90 10

### ROSE BUDDING

3.90 20

### FRUIT TREE BUDDING

3.90 40

### ALL PURPOSE

3.90 50

### LIGHT GRAFTING AND PRUNING

3.90 60

### ALL PURPOSE BUDDING KNIFE

3.91 10



### PRUNING OR LARGE TREE GRAFTING

1.92 00

*Rosewood handle*

### HEAVY PRUNING AND DESUCKERING

1.93 00

*Rosewood handle*



### PARING KNIVES

882-R

*Pointed blade*

891-R

*Straight blade*





# GREEN RANGE



## FELCO POCKET KNIFE SERIES

Stainless steel blades | Made by SWIZA

### FELCO 500

*One line knife*

### FELCO 501

*One line knife with corkscrew*

### FELCO 502

*One line knife with screw driver*

### FELCO 503

*Two line knife with corkscrew*

### FELCO 504

*Two line knife with screw driver*

### FELCO 505

*Three line knife with corkscrew*

### FELCO 506

*Three line knife with screw driver*



F501



F502



F503



F504



F500



F505



F506

# GREEN RANGE



## SAWS

### FELCO 600

Folding saw - blade 160 mm/6.3 in  
Spare blade part # 600/3



### FELCO 621

Fixed blade 240 mm/9.5 in  
Sheath included  
Spare blade part # 621/3



F621



### FELCO 611

Fixed blade 330 mm/13.0 in  
Sheath included  
Spare blade part # 611/3

F600



F611

### FELCO 640

Fixed blade 270 mm/10.5 in  
Sheath included  
Spare blade part # 640/3



F640

### FELCO 630

Fixed blade 330 mm/13.0 in  
Sheath included  
Spare blade part # 630/3



F630

## ACCESSORIES

### MAINTENANCE

#### F902

Ceramic sharpener

#### F903

Diamond coated sharpener

#### F904

Metallic ceramic insert sharpener

#### F980

Cleaning spray

#### F990

Grease



F902



F903



F904



F980



F990

# GREEN RANGE



## ACCESSORIES

### LEATHER HOLSTERS

#### FELCO 910

*Flat with clip and belt loop*



F910

#### FELCO 910+

*F910 with side pouch for F903*



F910+

#### FELCO 911

*Double holster with belt and clip, vertical*



F911

#### FELCO 912

*Cone with clip*



F912

#### FELCO 916

*For electric pruner*



F916

#### FELCO 918

*For small lopper pouch for F903  
Not pictured*

#### FELCO 919

*F910 with belt loop only*



F919

#### FELCO 920

*Two cones, with belt loop only pruner  
Not pictured*



F921

#### FELCO 921

*Double holster with belt and clip  
(side by side)*

#### FELCO 923

*Elongated specifically for the F13*



F923

# INDUSTRIAL RANGE



## CABLE CUTTERS

### FELCO CDO

One-hand  
capacity 5mm/0.2 in  
For cutting barbed wire



CDO

### FELCO CP

One-hand  
Universal cutter



CP

### FELCO C3

One-hand  
capacity 3 mm/0.12 in



C3

### FELCO C7

One-hand  
capacity 7 mm/0.28 in



C7

### FELCO C9

Two-hand  
capacity 9 mm/0.35 in

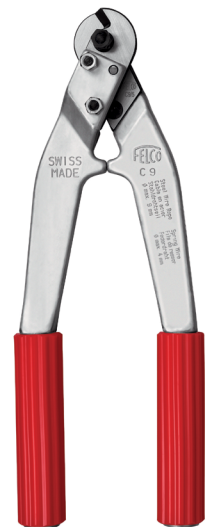

C9

### FELCO C12

Two-hand  
capacity 12 mm/0.47 in



C12



C16



C16E

### FELCO C16

Two-hand  
capacity 16 mm/0.63 in

### FELCO C16E

Two-hand  
capacity 20 mm/0.80 in  
Specifically built for electrical cable  
(not for live cable)

### FELCO C108

Two-hand  
capacity 12 mm/0.50 in  
With cam action



C108

### FELCO C112

Two-hand  
capacity 12.7 mm/0.50 in  
With cam action



C112



# POWER ASSISTED RANGE | FELCOmatic



## PNEUMATIC PRUNING SHEARS *Strength, rapidity, efficiency and reliability*

### FELCO 70

*Standard version*

*Cutting capacity: 30 mm/1.2 in*

*Weight: 710 gr/1.6 lb*

*Pressure: 7-15 bars/100-210 psi*

*Compressor flow should be:*

*-35 to 60 l/min*

*-1.25 to 2.00 cubic ft/min*

#### F73

*with progressive action*

#### F75

*with 600 mm/2 ft extension*

#### F76

*with 1200 mm/4 ft extension*

#### F77

*with 1500 mm/5 ft extension*



## MAJOR SPARE PARTS FOR PNEUMATIC SHEARS *Visit [felco.com](http://felco.com)*

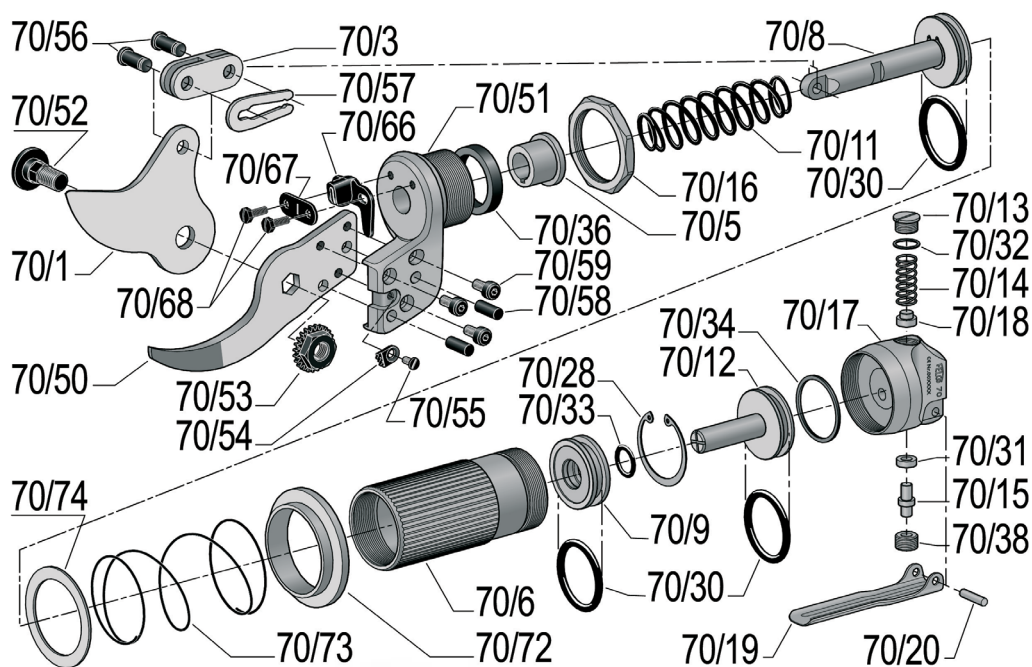

# POWER ASSISTED RANGE | FELCOtronic



## ELECTROPORTABLE PRUNING SHEARS

Strong, rapid, ergonomic, efficient and reliable

### FELCO 801

*Medium cutting head*

*Nominal cutting capacity: 25 mm/1.0 in*

*Weight: 745 gr/26.3 oz*



F801

### FELCO 811

*Large cutting head*

*Nominal cutting capacity: 35 mm/1.4in*

*Weight: 815 gr/28.7 oz*



F811

### FELCO 822

*Extra large cutting head*

*Nominal cutting capacity: 45 mm/1.8 in*

*Weight: 980 gr/34.7 oz*



F822

### FELCO 880/100-100

*1.0 meter, 3 ft. extension pole compatible with:*

*FELCO 801*

*FELCO 811*

*FELCO 822*

### FELCO 880/100-150

*1.5 meter, 5 ft. extension pole compatible with:*

*FELCO 801*

*FELCO 811*

*FELCO 822*

### FELCO 882 POWERPACK

*Universal fit for F801 / F811 / F822*

- 5 unique carry configurations
- Bluetooth-enabled with FELCO application
- Customizable fit for each user



F880/100-100



F880/100-150



F882

# POWER ASSISTED RANGE | FELCOtronic



## MAJOR SPARE PARTS FOR ELECTRIC SHEARS

Visit [felco.com](http://felco.com)



800F | for F800 and F801  
*Small cutting head*



800M | for F800 and F801  
*Hoof shear cutting head*

BLADES	F800	F800G	F801	F801G	F810	F811A	F811B	F822
800F/1								
800G/1		LEFT		LEFT				
800M/1								
801/1								
810/1								
811A/1								
811B/1								
820/1								

ANVIL BLADES	F800	F800G	F801	F801G	F810	F811A	F811B	F822
800F/2								
800G/2		LEFT		LEFT				
800M/2								
800/2								
810/2								
811A/2								
811B/2								
820/2								

### FELCOtronic GREASE PUMP REFILL 991/1

### FELCOtronic CHARGER 880/290



991/1



880/290

### FELCOtronic BATTERIES

#### 880/193 *Single capacity LiPo battery*

#### 880/194 *Double capacity Li-Ion battery*



880/193



880/194

# MARKETING MATERIAL

More marketing material available on request | Please visit [felco.com](http://felco.com)



## DISPLAYS

92331

Large display with feet  
200x60x20 cm/80x24x8 in  
Without tools



92331

92332

Half display without feet  
100x60x20 cm/40x24x8 in  
Without tools



92332

92333

Small display without feet  
60x40x20 cm/24x16x8 in  
Without tools



92333

92355

Rotating Display  
38x25x25 cm / 18x10x10 in  
Without tools



92355 with 92356

## DISPLAYS ACCESSORIES

92334

Demo tool (F8) with attachment



92334

92321

Feet for half or small display



92321

## CATALOGS

All catalogs available in PDF | Other catalogs, brochures and flyers available upon request

90804

FELCO general catalog

90103

FELCO green range catalog

90415

F801 Leaflet

90416

F811 Leaflet

90521

Power Blade series leaflet



# MARKETING MATERIAL



## SWISS ARMY KNIVES

---

91015

*Victorinox knife - medium*

91016

*Victorinox knife - large*



91015



91016

## POUCHES

---

P731

*Leather pouch*

*For Victorinox knife # 91016*



## PENS

---

91055

*Ballpoint pen (pack of ten)*



## HATS

---

91146

*Redcap with FELCO logo*

*One size fits all*



# TINA KNIVES



## T600A-12

*Extra heavy grafting knife*



T600A-12

## T605

*Grafting and all purpose knife  
Also available in left handed: T605L*



T605

## T606

*Grafting knife for berries*



T606

## T607

*Grafting knife for gooseberries  
Narrow curved blade*



T607

## T608

*Grafting and cutting knife in one*



T608

## T683

*Grafting knife American pattern  
Fixed blade*



T683

## T685

*Grafting knife standard pattern  
Fixed blade and handle similar to T605*



T685

# TINA KNIVES



## T640-10

*Budding and grafting knife*  
*Also available in left handed: T640-10L*



T640-10

## T641-10

*Budding knife standard pattern*  
*Also available in left handed: T641-10L*



T641-10

## T642-10

*Budding knife with special pattern*



T642-10

## T645-9F

*Budding knife for roses*  
*Fixed brass barklifter*



T645-9F

## T648-10

*Budding knife for fruit trees*  
*Curved blade, gaucher pattern*



T648-10

## T650-105E

*Budding knife for alitarian pattern*  
*Buffalo horn handle with pointed barklifter*



T650-105E

## T650-105S

*Budding knife with Steinfurth pattern*  
*Buffalo horn handle with curved barklifter*



T650-105S

## T671

*Walnut/pecan budding knife*  
*Two fixed blades and brass barklifter*



T671

# TINA KNIVES



## T613-105

*Light pruning knife  
Can also be used as grafting knife*



T613-105

## T620-10

*Pruning knife for garden and nursery*



T620-10

## T626-11

*Medium to heavy pruning knife for nursery*



T626-11

## T630-11

*Heavy pruning knife*



T630-11

## T900

*Bow saw  
Spare blade T900-3  
Blade length: 350 mm/13 in  
Weight: 450 gr/16 oz*

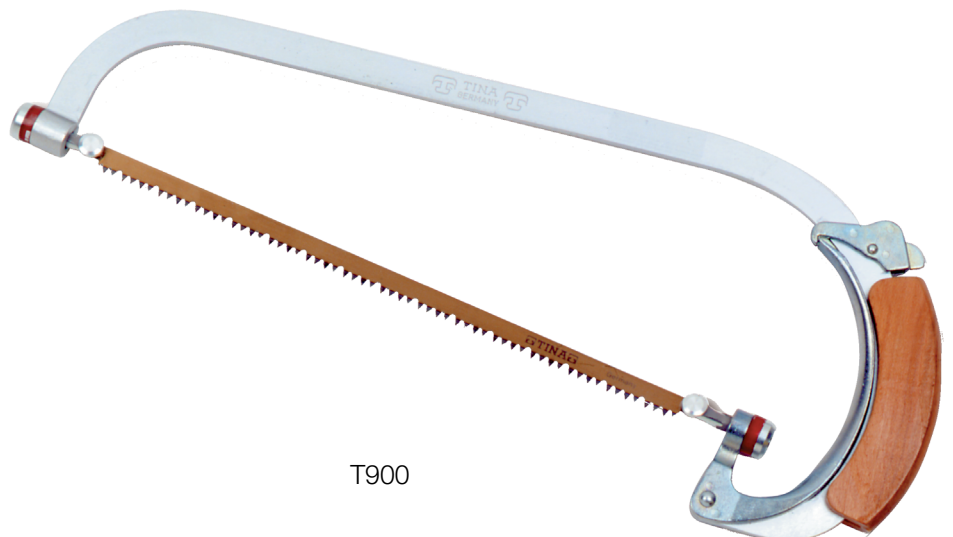

T900

## T940

*Fine grain sharpening stone  
One side flat, one side curved  
Not pictured*

# SWISS ISTOR SHARPENER



## I-10

*Standard - with metallic ceramic insert*  
*Length: 100 mm/3.9 in*  
*Weight: 24 gr/0.8 oz*



I-10

## I-15

*Professional - with ergonomic handle*  
*Length: 145 mm/5.7 in*  
*Weight: 48 gr/1.7 oz*



I-15

## I-20

*Duplex - with diamond grinder*  
*Length: 190 mm/7.5 in*  
*Weight: 96 gr/3.4 oz*



I-20



## B-4490

*Hedge shear with straight blades*

*Overall length: 540 mm/21.3 in*

*Blades length: 235 mm/9.3 in*

*Weight: 1020 gr/2.2 lb*

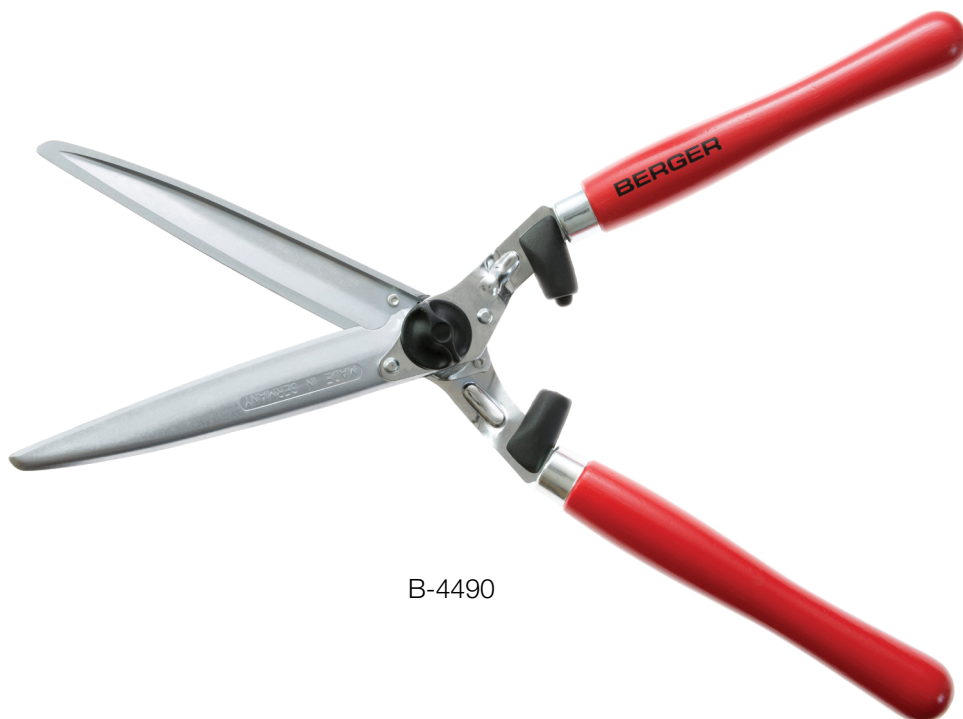

B-4490

## B-4590

*Hedge shear with wavy blades*

*Overall length: 540 mm/21.3 in*

*Blades length: 240 mm/9.4 in*

*Weight: 1020 gr/2.2 lb*

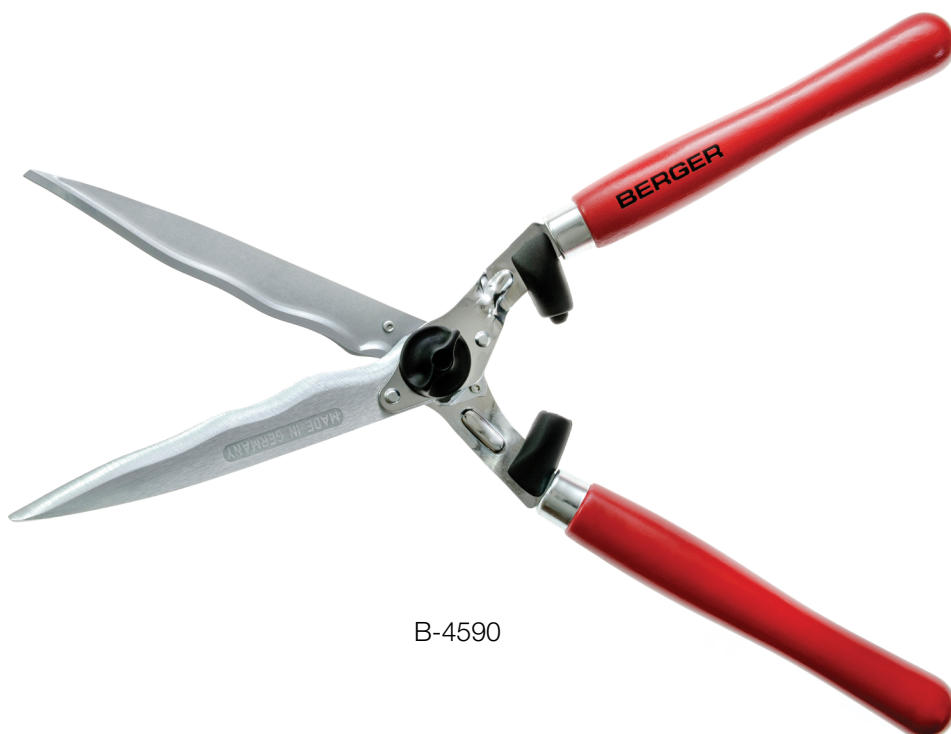

B-4590

## HAYATE POLE SAW - XLG TEETH

Blade length: 420 mm/16.5 in

Spare blade: H-373-42 (SILKY ref. 373-42)

### H-371

(SILKY ref. 371-42)

Max. 4.99 m/16.4 ft -2 ext.

Weight: 3080 gr -6.8 lb

Sheath included

### H-372

(SILKY ref. 372-42)

Max. 6.10 m/20.0 ft -3 ext.

Weight: 3950 gr/8.7 lb

Sheath included

## HAYAUCHI POLE SAW | XLG TEETH

Blade length: 390 mm/15.4 in

Spare blade: S-78-3 (SILKY ref. 177-02-03)

### S-78

(SILKY ref. 178-39)

Max. 4.90 m/16.0 ft -2 ext.

Weight: 2160 gr/4.8 lb

Sheath included

### S-79

(SILKY ref. 179-39)

Max. 6.30 m/21.0 ft -3 ext.

Weight: 3060 gr/6.7 lb

Sheath included

## ZUBAT CURVED SAW | LG TEETH

Blade length: 300 mm/11.8 in

Spare blade: S-300-3 (SILKY ref. 271-30)

### S-300

(SILKY ref. 270-30)

Overall length: 445 mm/17.5 in

Weight: 280 gr/0.6 lb

Sheath included

## ZUBAT POLE SAW | LG TEETH

Blade length : 330 mm/13.0 in

Spare blade: S-330-3 (SILKY ref. 271-33)

### S-330

(SILKY ref. 272-15)

Max. 3.30 m/11.0 ft -1 ext.

Weight: 1500 gr/3.3 lb

Sheath included

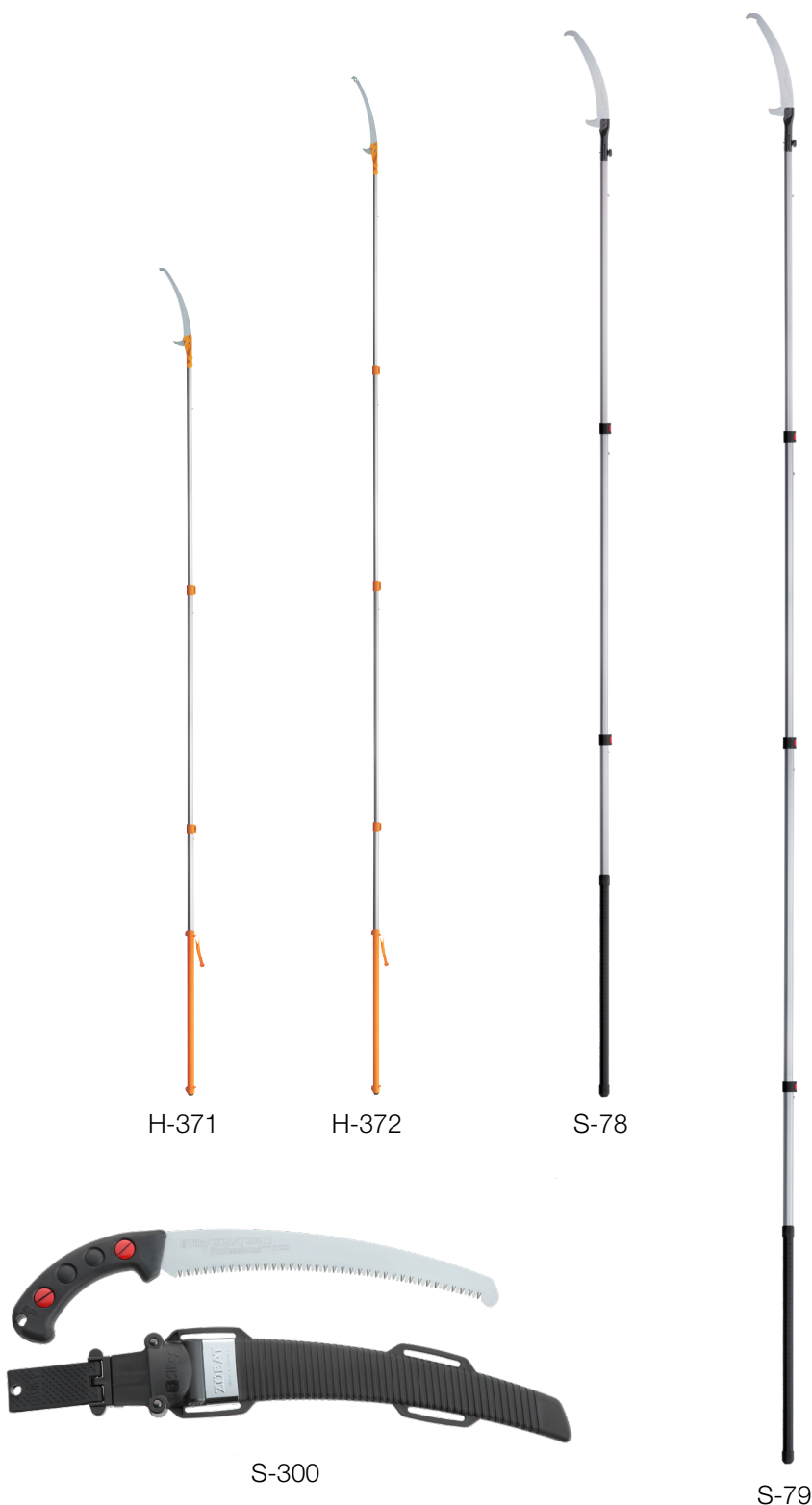



**PYGAR companies are part of the FELCO group**

**PYGAR USA Inc.**

5470 Shilshole Ave NW  
Suite 302  
Seattle, WA 98107  
[pygar.us](http://pygar.us) | [info@pygar.us](mailto:info@pygar.us)

**PYGAR Sales Canada Ltd.**

PO Box 75548  
RPO Edgemont Village  
North Vancouver, BC V7R 4X1  
[pygar.ca](http://pygar.ca) | [info@pygar.ca](mailto:info@pygar.ca)

Phone 206-258-2901 | Fax 206-258-2620